

# Instruction Guide

## Classic Tractor Seat Stool

**Tools Needed**

- 2 - 7/16" Wrenches
- 1 - 15/16" Wrench
- 1 - 3/8" Wrench

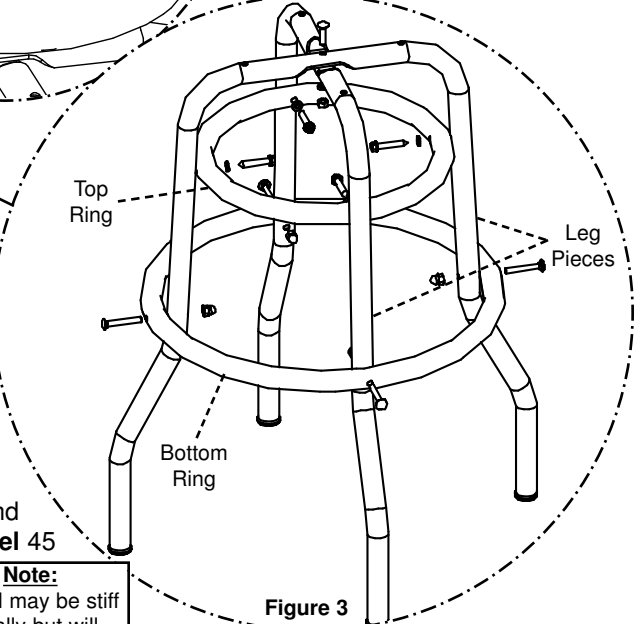
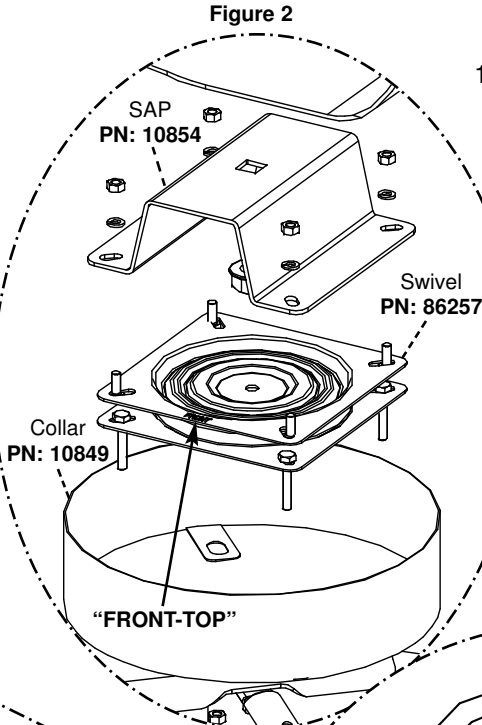
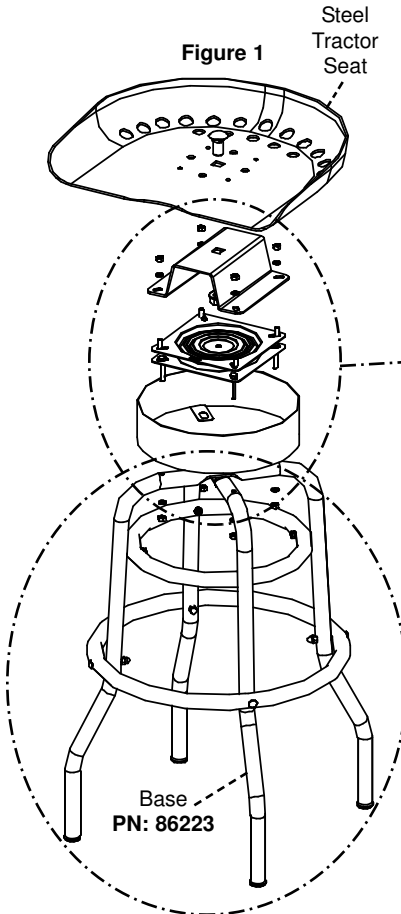

1. Bolt the two **base leg pieces** together through the top center holes using one 1/4" x 1" carriage bolt, lock washer and nut.
2. Fasten the bottom ring of the base around the outside of the **legs** using four 1/4" x 1 3/4" carriage bolts and 1/4" acorn nuts.
3. Fasten the **top ring** of the base along the inside of the **legs** using four #14 x 1 1/2" sheet metal screws and lock washers.  
**Do not over-tighten screws!**

4. Place the **seat adapter plate (SAP)** on the bottom of the **seat**. Fasten with one 5/8" x 1 1/2" carriage bolt and flange nut.
5. Locate the stamped portion of the **swivel** that is marked "FRONT-TOP". Place the **swivel** onto the **SAP** with the stamped "FRONT-TOP" marking towards the **seat** side and to the front of the **seat**. Rotate the **base** side of the **swivel** 45 degrees to allow easier access to the bolt holes. Fasten the **seat** side of the swivel to the **SAP** using four 1/4" x 5/8" bolts, lock washers and nuts. **Important! - Bolts used to fasten the swivel to the SAP MUST have the bolt threads turned towards the seat.**

**Note:**  
Swivel may be stiff initially but will loosen with use.

6. With the **base** side of the **swivel** still rotated 45 degrees from the **seat** side, align the **collar** tab slots with the **base** side of the **swivel** and place on top of the assembled **base**.
7. Attach the swivel assembly and the collar to the base using four 1/4" x 1 1/2" bolts, lock washers and nuts.