

Installation Guide

Classic Series Farmall 30" Stool

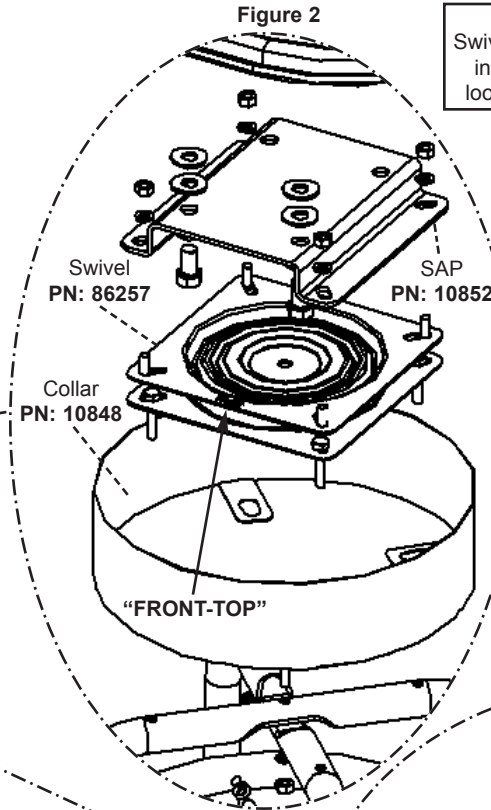
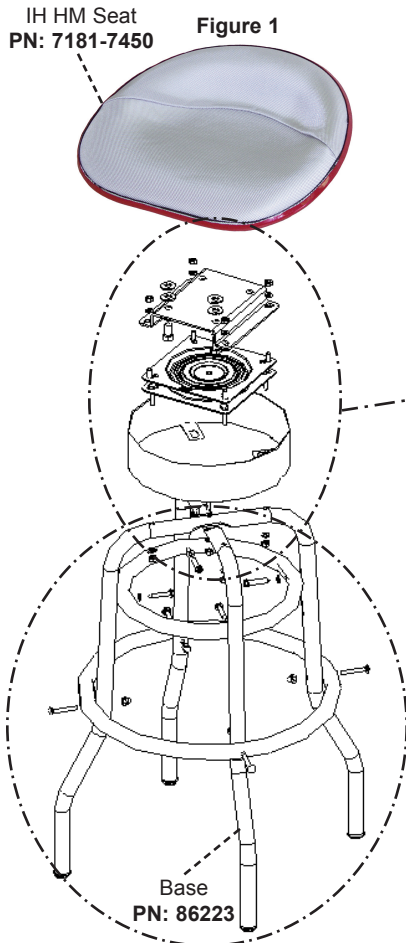

Note:
Swivel may be stiff initially but will loosen with use.

Tools Needed
1 - 3/8" Wrench
2 - 7/16" Wrenches
1 - 5/8" Wrench

1. Bolt the two **base leg pieces** together through the top center holes using one 1/4" x 1" carriage bolt, lock washer and nut.
2. Fasten the bottom ring of the base around the outside of the **legs** using four 1/4" x 1 3/4" carriage bolts and 1/4" acorn nuts.
3. Fasten the **top ring** of the base along the inside of the **legs** using four #14 x 1 1/2" sheet metal screws and lock washers. **Do not over-tighten screws!**
4. Place **seat** upside down on a clean work bench or table with the flat edge of the **seat** facing towards you as shown in **Figure 4**.

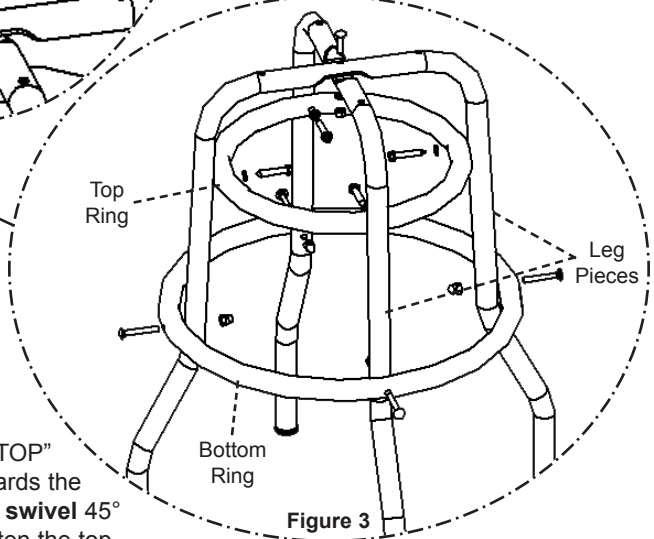

5. Place the **seat adapter plate (SAP)** on the bottom of the **seat**. Fasten with four 7/16" x 3/4" bolts & lock washers. (Note: The standard **swivel** provides a three degree tip back. For additional tip back, place one or two 3/8" flat washers provided between the **SAP** and the **seat** on each of the front two fastening holes.)
6. Locate the stamped portion of the **swivel** that is marked "FRONT-TOP" and place the **swivel** onto the **SAP** with the stamped marking towards the **seat** side and to the front of the **seat**. Rotate the **base** side of the **swivel** 45° as shown in **Figure 4** to allow easier access to the bolt holes. Fasten the top of the swivel to the **SAP** using four 1/4" x 5/8" bolts, lock washers and nuts. **Important! - Bolts used to fasten the swivel to the SAP MUST have the bolt threads turned towards the seat.**
7. With the **base** side of the **swivel** still rotated 45° from the seat side, align the **collar** tab slots with the **base** side of the **swivel** as shown in **Figure 4**.
8. Carefully place one 1/4" x 5/8" bolt with the thread facing towards the **base** side through **Point A** as shown in **Figure 4**. With the bolt held in place, set the assembled **base** on to the bolt and fasten finger tight with a 1/4" lock washer and nut.
9. Rotate the **base** side of the **swivel** 90° and repeat step 9 until all four bolts are fastened finger tight. After all bolts are in place, continue cycling through the bolts and tighten to securely affix the base to the swivel.

