

## Installation Guide

### John Deere Soundguard Mirror (PN: 3127)

**Fits:**  
All Soundguard Cabs 30-40-50 Series,  
Row Crop & 4WD Series

**NOTE:** Mirror can be used on either the right or left side.

1. Remove the two center bolts from the rubber molding above the side window.
2. Install the **angle bracket** with the lip up using two 1/4" x 1 1/2" bolts and flat washers.
3. Remove the 5/8" bolt from the top of the tractor cab.
4. Bolt the **mounting bracket** to the top of the cab with the original bolt and to the **angle bracket** with two 5/16" x 3/4" bolts, lock washers and nuts. Place the **foam seal** between the **mounting bracket** and top of the cab.
5. Fasten the **mirror arm assembly** to the **mounting bracket** with two 5/16" x 1" full thread bolts, flat washers, lock washers and nuts.

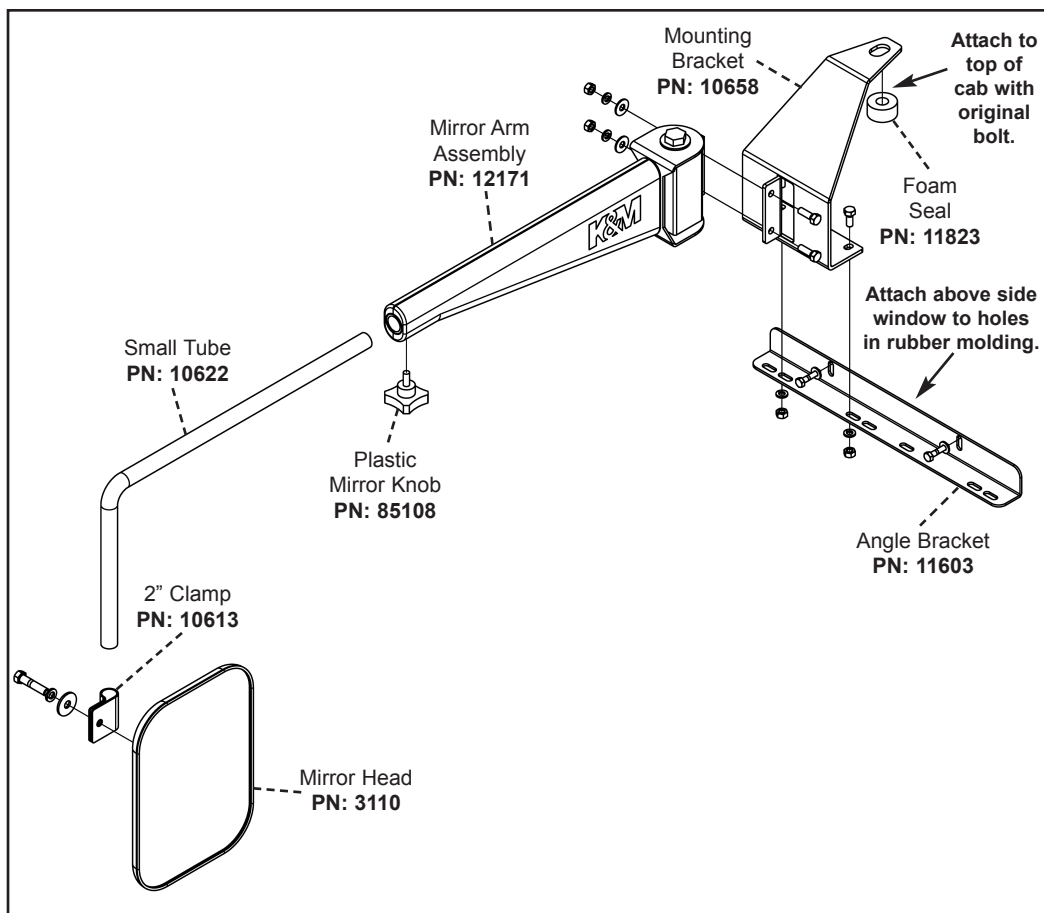

6. Insert the **small tube** into the **mirror arm assembly** and secure with the **plastic mirror knob**.

### Note!

*Do not overtighten the plastic mirror knob.*

7. Fasten the **mirror head** to the **small pipe** with the **2\"**