

## CIH Combine Mud Scraper Fits CIH 5088, 6088, 7088 Series Combines

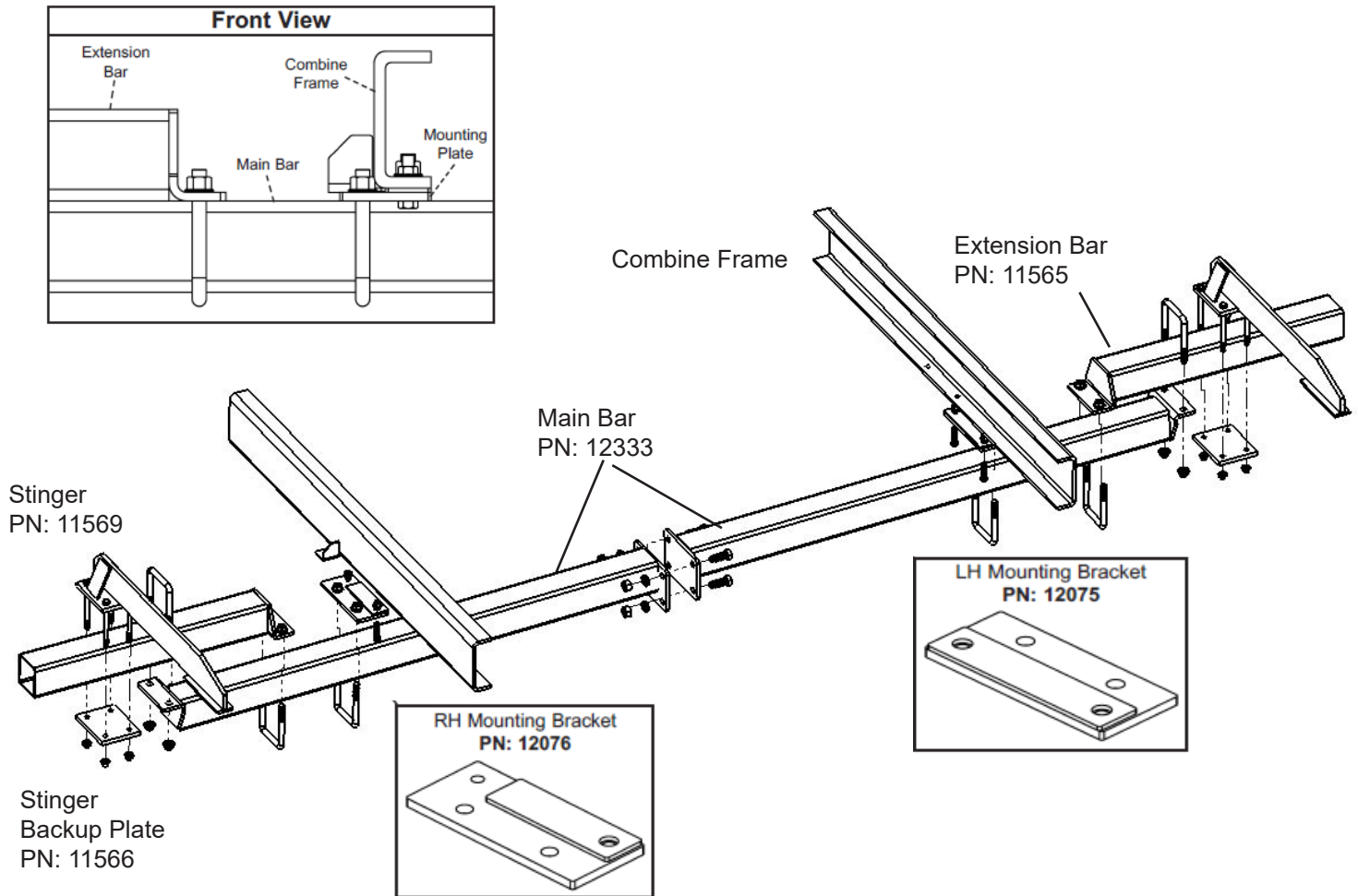

1. Attach the mounting brackets to the combine frame using the four 1/2" x 2" bolts and flange nuts.
2. Bolt the two sections of the Main Bar together with four 3/4-10 x 2" bolts, lockwashers and nuts.
3. Attach the main bar to the mounting brackets using two 5/8" x 4" u-bolts and four 5/8" flange nuts.
4. Attach the extension bars to the main bar at the desired position. Fasten with two 5/8" x 4" u-bolts and four 5/8" flange nuts on each end.
5. Attach the stingers to the extension bar using the stinger backup plate. Fasten with four 1/2" x 6" bolts and flange nuts on each end.