

Installation Guide

Nite-Gard™ CIH 71-72-89 Magnum (PN: 3298)

1. Hold the **CIH 71-72-89 Magnum Mount** up to the rear 1" x 2" steel tube as shown in Figure 1 below. Mark drilling locations of all four holes. The holes have to be marked to one side of the slots as shown in Figure 2 below. The holes on the side need to be marked at the back of the slot towards the rear of the tractor. The holes on the back need to be marked to the outside of the slot, away from the tractor.
2. Drill four 21/64" holes where the marks are.
3. Install the rivet nut as follows. See Figure 3.
 - A. Tap the **rivet nut** into the 21/64" hole.
 - B. Hold the **handle** firmly against the **rivet nut** and draw up the bolt until it clinches. **DO NOT OVERTIGHTEN!!**
 - C. Remove the **bolt**, **washer** and **handle**. Discard **handle** at this time.
4. Fasten the **CIH 71-72-89 Magnum Mount** to the tractor using four 1/4" x 3/4" bolts and lock washers on each side.
5. Mount the warning light to the **CIH 71-72-89 Magnum Mount** using two 3/8" x 1" bolts and flange nuts.
6. Locate the flasher circuit on the tractor. Connect one wire to the flasher circuit and ground the other wire. Be sure to trim the wire on the warning light arm and discard any excess wire.
7. Loosen the extension knob and extend the light to desired position. Re-tighten, do not overtighten.



Figure 1

Mount Location

CIH 71-72-89 Magnum Mount PN:
10868 (Right Hand)
10869 (Left hand)

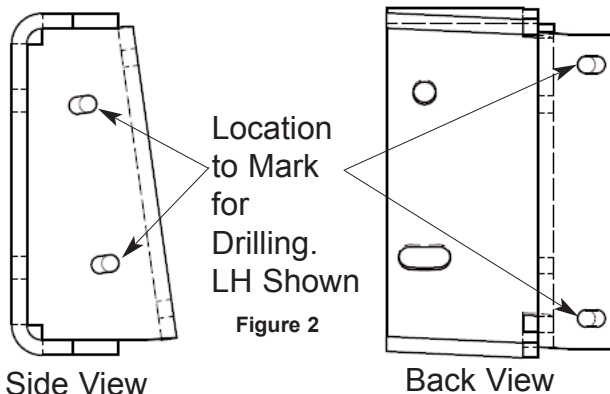
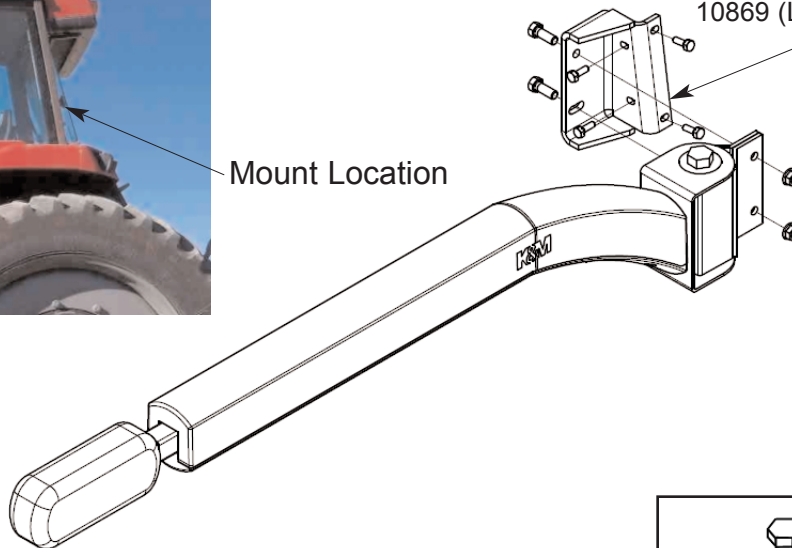

Figure 2

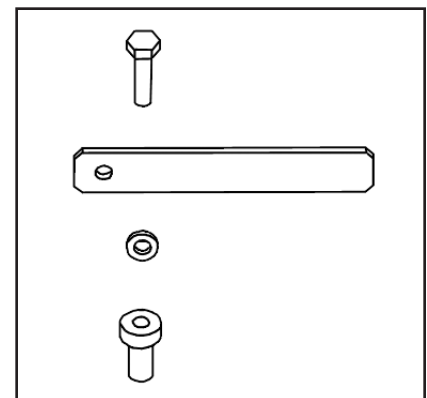

Figure 3