

## Installation Guide

### Installation Instructions to Assemble KM 1061 Uni Pro Seat & Suspension in CIH 5100-5200 Maxxum Series Tractors

KM 1061 Uni Pro Seat  
& Suspension PN: 8528



PN: 6123

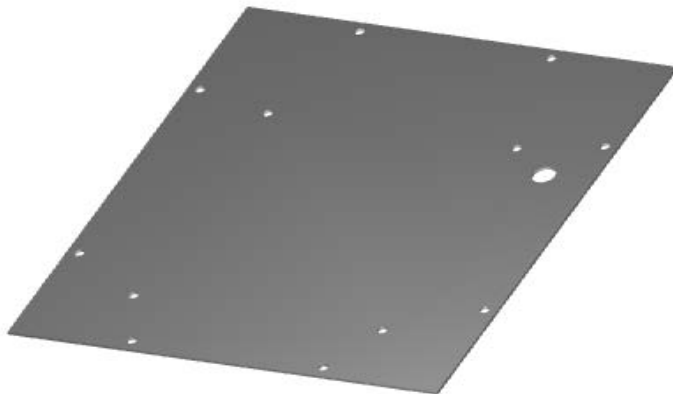

1. Remove old seat and suspension by removing eight 8mm bolts from the seat mounting plate around the bottom of the seat base. Unplug wire harness from seat. Remove seat from cab.  
**NOTE:** If a swivel is to be installed follow the installation instructions for swivel.
2. Install new seat assembly on seat mounting plate with four 8mm 1.25" x 20mm bolts and flange nuts.
3. Install the seat with the attached mounting plate into position and install the eight bolts removed in step 1.
4. Connect the wire harness supplied in mounting kit to back of seat. Feed harness through hole in mounting plate and connect other end of harness to tractor plug located underneath the cab.

**NOTE:** The KM 1061 seat is equipped with an Operator Presence Switch, if the tractor is not the wire harness can be tied up and tucked out of the way.