

KM 1310 Uni Pro
Seat & Suspension
PN: 8276

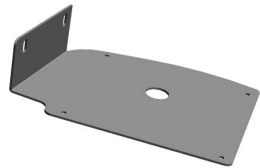

PN: 6118

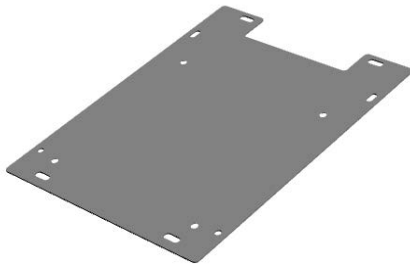

PN: 6121

Installation Instructions KM 1310 Uni Pro Seat and Suspension in John Deere 7020-7030 Series Tractors with ITV Transmissions

1. Remove the original seat and suspension from the tractor along with the seat mounting plate. Keep mounting hardware for later use.
Note: RH arm rest needs to be removed.
2. If installing swivel or if tractor is equipped with Command Arm install the swivel PN 5007 and Command Arm Bracket PN 6118 now.
Note: See install guide included with each kit.
3. Attach seat assembly to mounting plate PN 6121 as shown with tapered holes down. Install with four 8mm 1.25 x20mm tapered bolts and four 8mm flange nuts.
4. Place seat into position in cab use the bolts and hardware removed in Step 1. to fasten seat mounting plate in place.
5. To connect wiring use the wiring harness or adapter included in kit to plug and play on most models.