

1. Ensure the machine is in park and the key is removed. Block the machine to avoid rolling. It may be helpful to lift the machine to install the step.
2. Clean the area where the step is being installed.
3. Clamp the mounting bracket to the Toolcat inside the cab frame, below the door in the desired location front to back. Make sure the upper tabs of the mounting bracket are pressed up to the bottom of the machine. (See image below.)

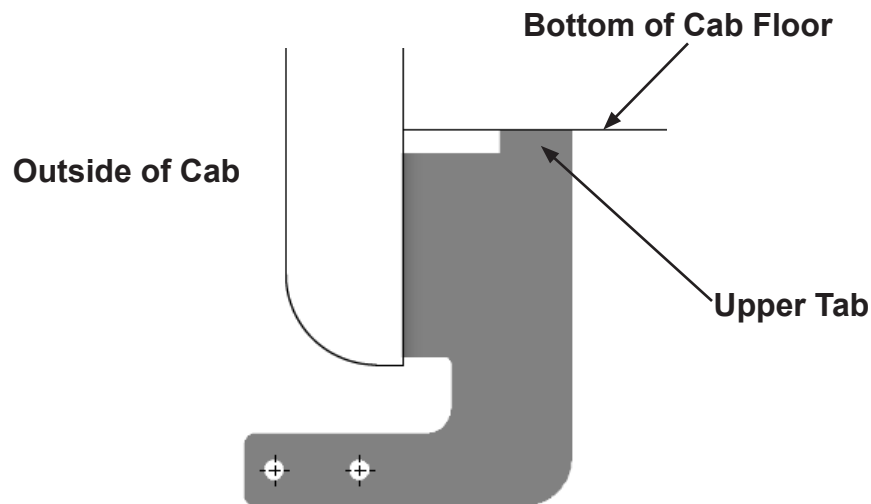

4. With the mount bracket clamped in place, mark or transfer punch the center of the four holes onto the mounting surface of the Toolcat.
5. Remove the clamp and the mounting bracket.
6. Center punch each of the four holes if a transfer punch was not used.
7. Label each of the four holes as 1/2".
8. Measure in towards where the center of the mounting bracket will be from each hole horizontally 0.75". Mark and center punch the additional four holes. It may be helpful to draw a horizontal line connecting the center of the previously labeled 1/2" holes.
9. Label each of the four inner holes as 3/4". (See the mounting hole diagram below.)
10. Drill the outer four holes to 1/2" in diameter. Drill only through the inner plate of the cab. It may be helpful to use a smaller bit first to make drilling easier.
11. Drill the inner four holes to 3/4" in diameter. Drill only through the inner plate of the cab. A hole saw is recommended for these holes.

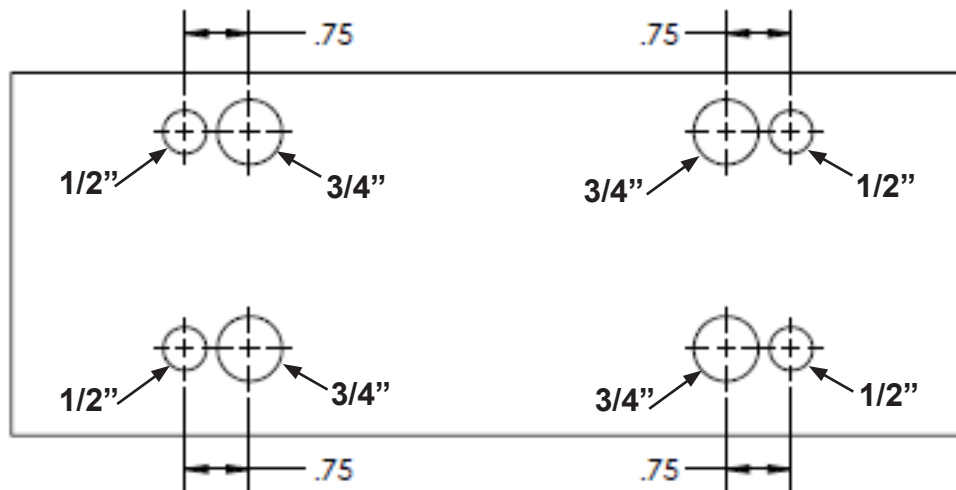

12. Install the 5/16-18 clip nuts as shown below. Insert them into the 3/4" hole so the barrel of the clip nut is inside the cab frame structure.

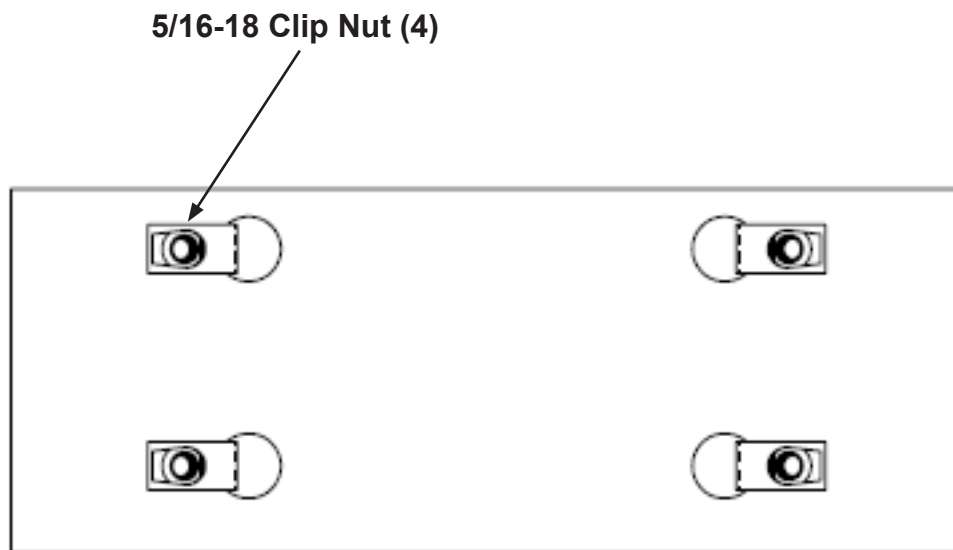

13. Assemble the step, rubber side straps, and mounting bracket using eight 3/8-16 x 1.00" bolts, eight 3/8-16 serrated flange nuts, and four backup plates as shown below.

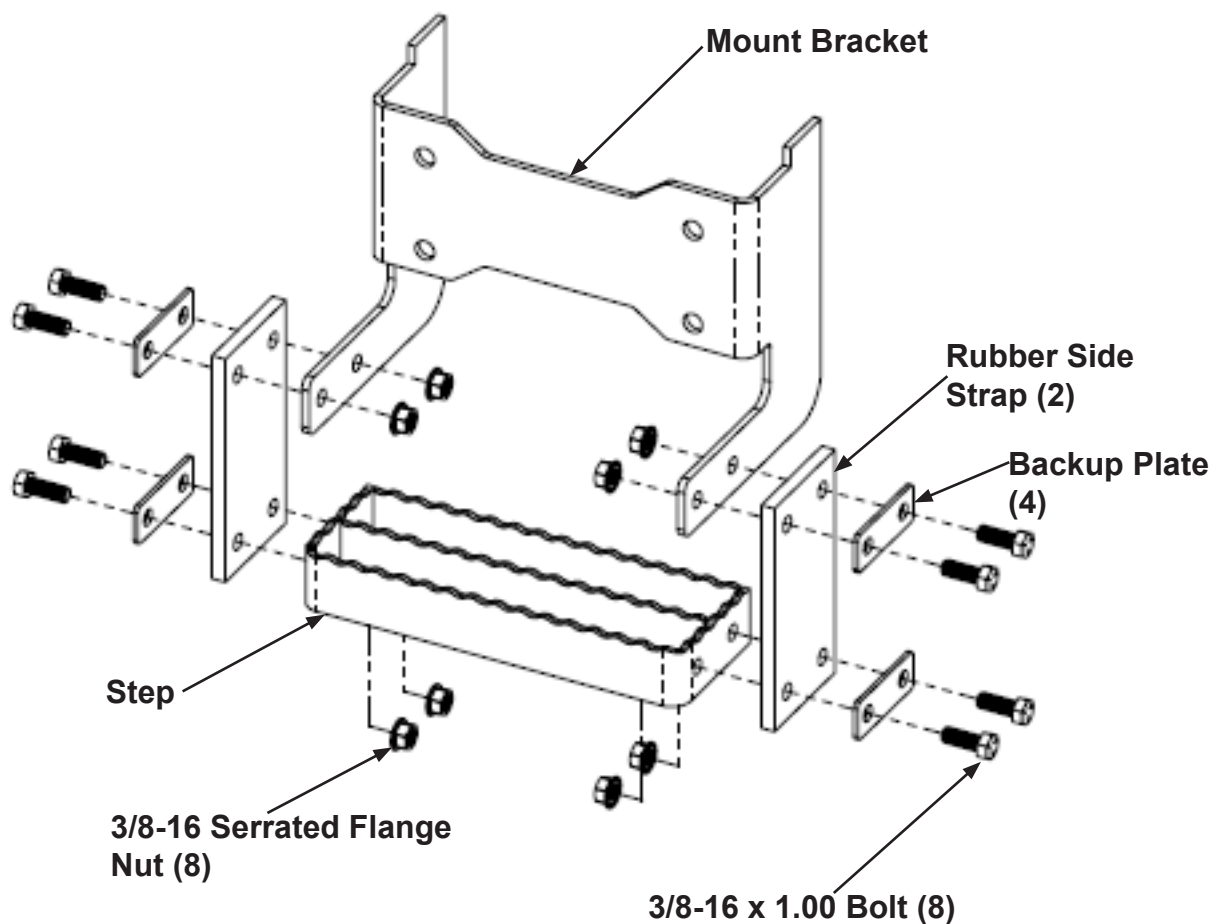

14. Install the step onto the Toolcat using four 5/16-18 x 1.00" bolts, four 5/16" lock washers, and four 5/16" flat washers.

