

Installation Guide

Window Step for CIH 235-340 Magnum Tier 4 (PN: 3351)

1. Bolt the **front step section** to the tractor using two 20mm x 45mm bolts and 3/4" flat washers.
2. Fasten the **side step section** to the **front step section** using four 5/16" x 1" bolts and flange nuts.
3. Fasten the upper part of the **support bracket** to the **side step section** using four 5/16" x 1" bolts and flange nuts. **DO NOT TIGHTEN AT THIS TIME!**
4. Insert two 5/16" x 1" carriage bolts into the **backup plate**, then place the **backup plate** behind the lip on the bottom of the fuel tank with the carriage bolts going through the holes on the **support bracket**. Fasten with two 5/16" flange nuts.

5. Tighten the top bolts of the **support bracket**.
6. Attach the **support strap** to the **side step section** using a 5/16" x 1" carriage bolt and flange nut.
7. Attach the bottom end of the **support strap** to the square tube located near the bottom of the fuel tank using a 1/4" x 1-1/4" self-tapping screw.

8. Locate the **handrail** to the desired height on the muffler shield, and fasten together using four 5/16" x 1-1/4" bolts and flange nuts.

9. Attach the **riser plates** to the **front step section** using three 5/16" x 1" bolts and flange nuts on each. **USE OF THE FRONT STEP RISER PLATE IS REQUIRED FOR TRACTORS WITH DUAL FRONT WHEELS. INSTALLATION ON TRACTORS WITHOUT DUAL WHEELS IS OPTIONAL.**

10. Fasten the **front bolt-on steps** to the **riser plates** using three 5/16" x 1" bolts and flange nuts each. If installing on a tractor without dual wheels, the **front bolt-on steps** can be fastened directly to the **front step section**.

NOTE! - When Installing This Step

Do not tighten any bolts until all parts have been assembled to the tractor.

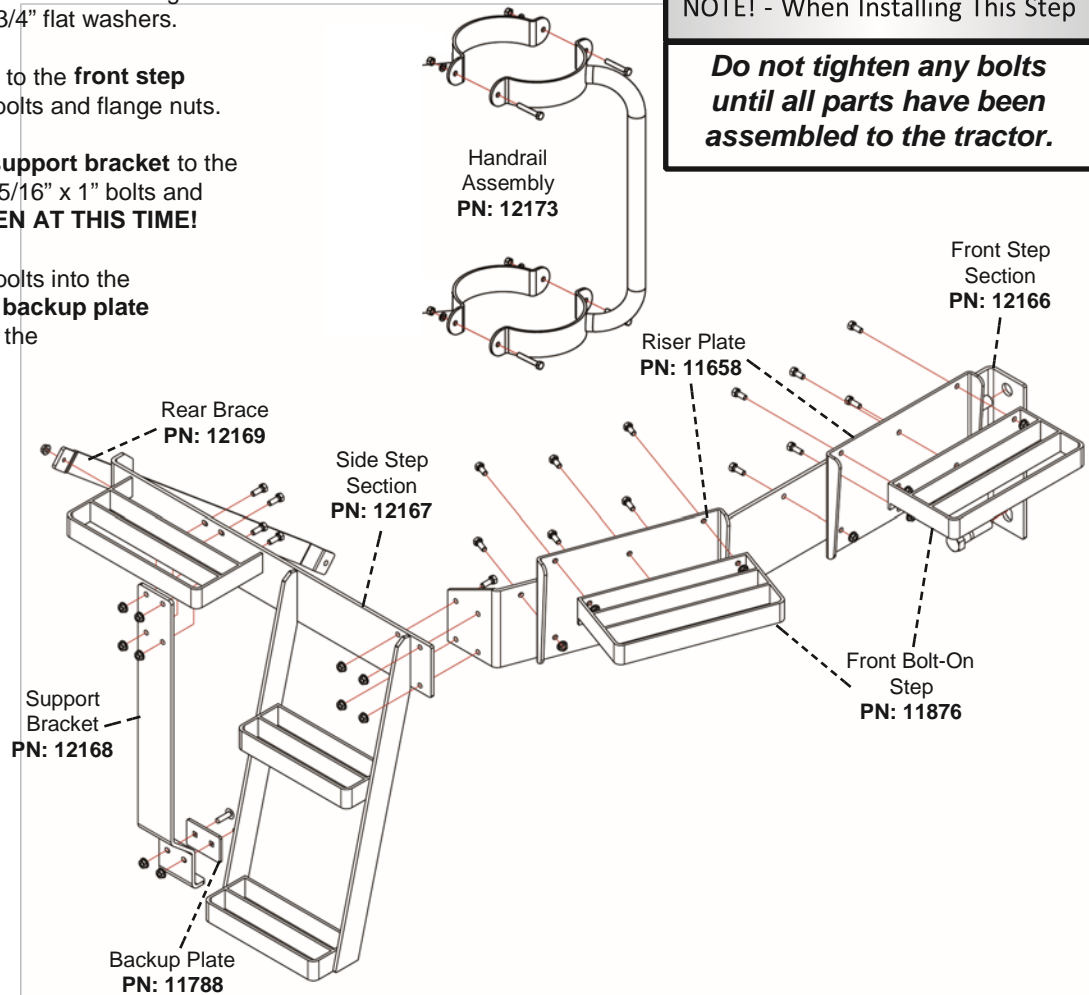

After step installation, check turning radius of front tires for any interference with the step.