

1. Remove the original step from the tractor.
2. Fasten the **mounting bracket** to the side of the tractor cab with two  $3/8" \times 1\ 1/2"$  carriage bolts and flange nuts. Use the original bolts in the bottom and rear holes.

3. Insert the **pivot arm** of the **top step section** into the **mounting bracket** and fasten with two  $5/8" \times 4"$  capscrews, lock washers and nuts.

4. Fasten the **bottom step section** along the outside of the **top step section** using four  $3/8" \times 3/4"$  carriage bolts and flange nuts.

5. Fasten the lower end of the **handrail** to the rear side of the **mounting bracket** with two  $3/8" \times 1"$  bolts and flange nuts.

6. Clamp the upper end of the **handrail** to the front side of the fender and drill two  $5/16"$  holes. Fasten with two  $5/16" \times 1"$  bolts and flange nuts.

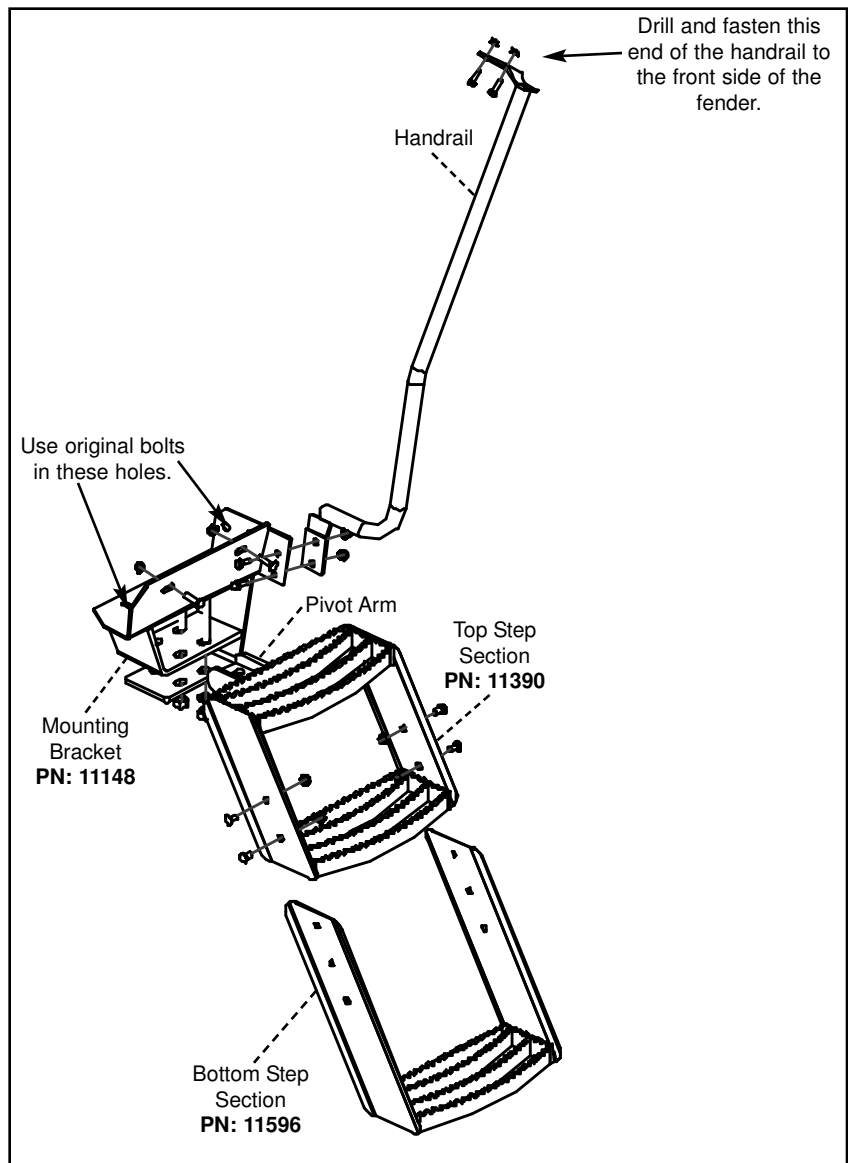

1. Remove the original step from the tractor.
2. Fasten the **mounting bracket** to the side of the tractor cab with two 3/8" x 1 1/2" carriage bolts, flat washers, lock washers and nuts. Use the original bolts in the bottom and rear holes.
3. Insert the **pivot arm** of the **top step section** into the **mounting bracket** and fasten with two 5/8" x 4" capscrews, lock washers and nuts.
4. Fasten the **bottom step section** along the outside of the **top step section** using four 3/8" x 3/4" carriage bolts and flange nuts.
5. Fasten the lower end of the **handrail** to the rear side of the **mounting bracket** with two 3/8" x 1" bolts, lock washers, flat washers and nuts.
6. Clamp the upper end of the **handrail** to the front side of the fender and drill two 5/16" holes. Fasten with two 5/16" x 1" bolts, lock washers and nuts.

