

1. Remove the plastic cap from the top of the mirror mount and remove the M10 bolt to remove the OEM mirror.
2. Reuse the rubber seal from the OEM mirror and fasten the PN 11052 mounting bracket with the M10-1.50 x 40mm flange bolt and two plastic cams PN 85089. Adjust to the desired angle and finger tighten.
3. Mount the mirror arm assembly PN 12171 to the mounting bracket with two 5/16-18 x 1.25 bolts, flat washer, lock washers and nuts.
4. Insert the small tube PN 10622 into the mirror arm assembly and secure with PN 85108 the plastic mirror knob.
DO NOT OVERTIGHTEN KNOB
5. Fasten PN 3110 mirror to the small pipe with clamp and bolt as shown.
6. Adjust the mounting bracket to the desired position and tighten the M10 bolt. Insert the plastic cap provided in the hardware kit.

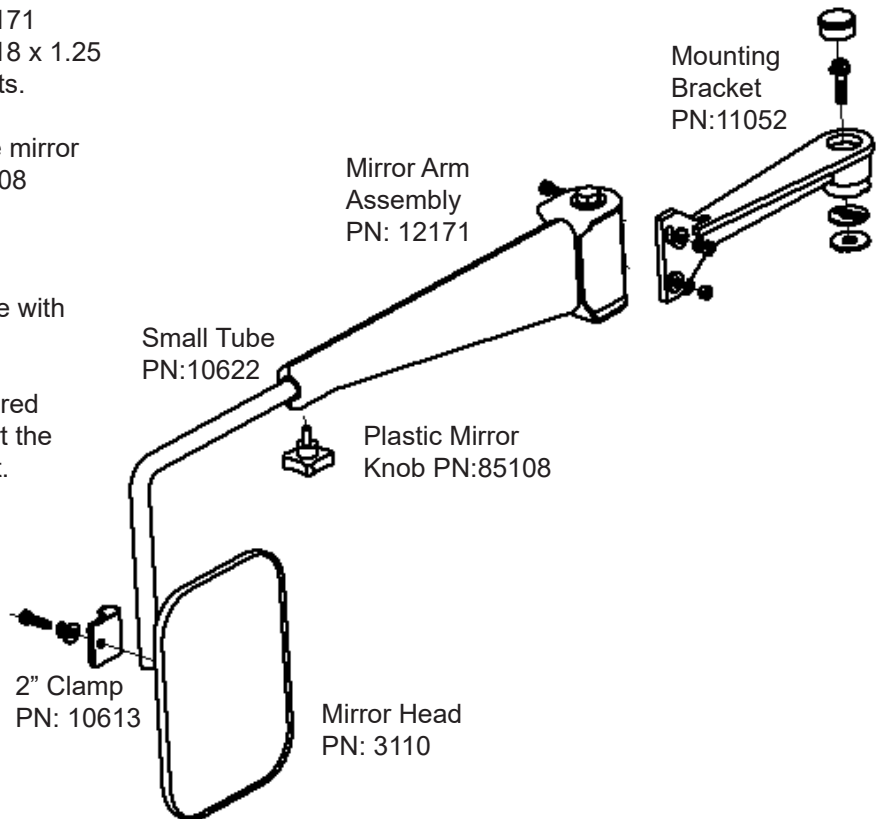

For tractors not equipped with an OEM mirror but the mirror mount hole on top of the cab this kit can be used by installing OEM mounting brackets and rubber seals purchased from John Deere. Have the serial number of the tractor available when ordering.