

Installation Guide

Case 10-20 Series Combine Toolbox (PN: 1527)

1. Remove the rear of the left hand platform service step. Keep all the original mounting hardware as it will be reused. You will have to remove the two bolts that hold the rear shield to the step as well.
2. Assemble the mounting parts to the new toolbox. NOTE: Cover is not shown for clarity.
3. Mount the Front Frame Mount and the Rear Mount plates to the toolbox using eight 5/16" x 3/4" carriage bolts and serrated flange nuts. Hand tighten only.
4. Mount the Inside Mount Plate to the toolbox using two 3/8" x 3/4" carriage bolts, four 5/16" x 3/4" carriage bolts, and serrated flange nuts. Hand tighten only.
5. Connect the Front Frame Mount and Rear Mount plates to the Inside Mount plate using four 5/16" x 3/4" hex bolts and serrated flange nuts. Hand tighten only.

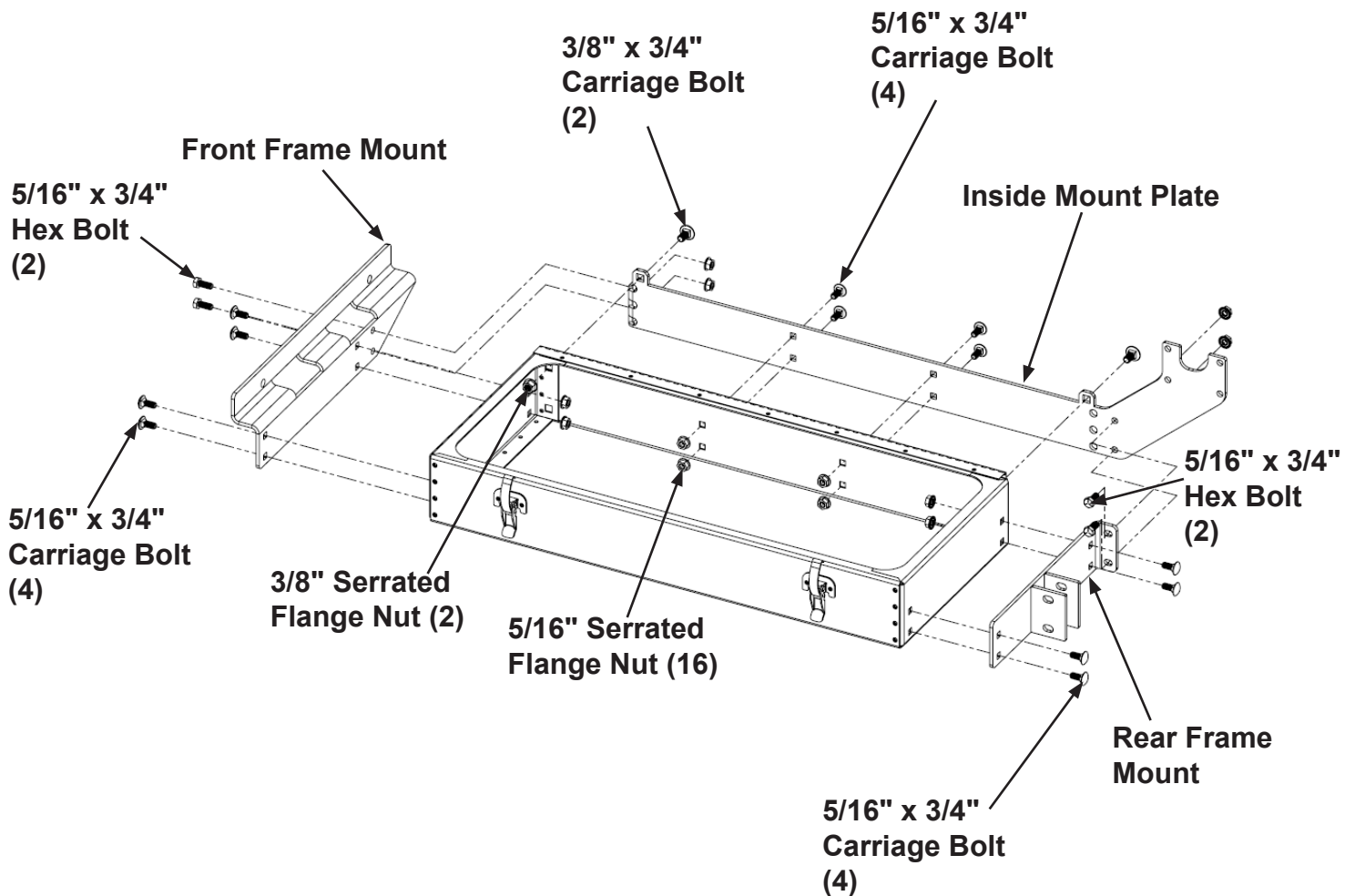

Installation Guide

Case 10-20 Series Combine Toolbox (PN: 1527)

6. Install the Pipe Mount to the toolbox using four 5/16" x 3/4" hex bolts and serrated flange nuts and two 3/8" x 2" hex bolts and serrated flange nuts.
7. Tighten all hardware.
8. Mount the toolbox assembly to the combine in the same location as the platform step was. Use the original hardware to mount it in place. Tighten all mounting hardware.

