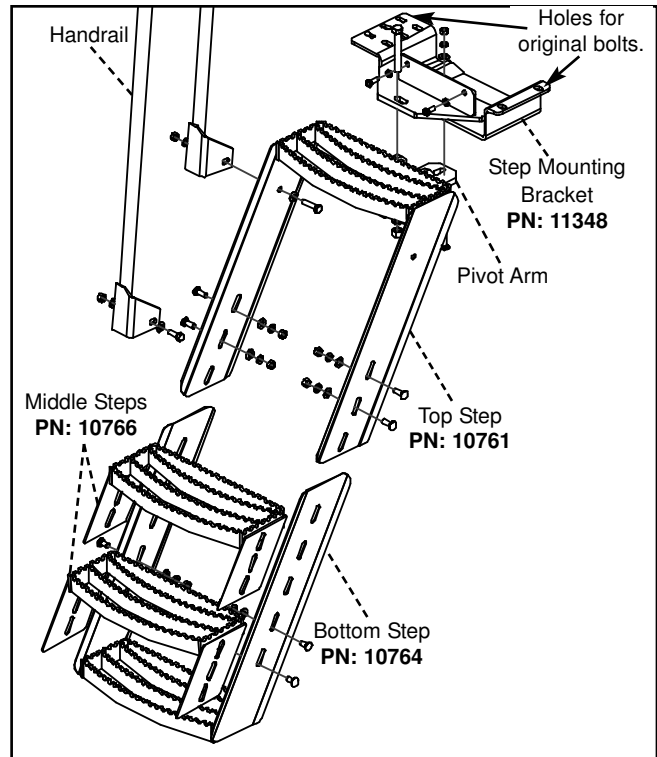

# Instruction Guide

## Case 90 Series Step & Handrail (PN: Step-3301 / Handrail-3336)

1. Remove the original step from the tractor cab.
2. Bolt the **step mounting bracket** to the cab using the four original step bolts.
3. Drill two 17/64" holes into the lower door frame to match the holes in the lip of the **mounting bracket** and secure with two 5/16" x 3/4" self threading bolts and lock washers.
4. Place the **pivot arm** of the **top step section** against the bottom of the **mounting bracket** and fasten with a 1/2" x 3 1/2" bolt, lock washer and nut; and a 3/8" x 1 1/2" carriage bolt, flat washer, lock washer and nut.
5. Rotate the step to the desired position and tighten all bolts securely.
6. Slide the **bottom step section** along the outside of the **top step section** to the approximate height and clamp it at that position.
7. The two **middle steps** should be positioned so that all steps are evenly spaced.
8. Fasten the **upper middle step** with four 3/8" x 1" carriage bolts, flat washers, lock washers and nuts.
9. Fasten the **lower middle step** with four 3/8" x 3/4" carriage bolts, flat washers, lock washers and nuts.
10. Fasten the upper end of the **handrail** to the side plate just below the **top step** with a 3/8" x 1" bolt, lock washer and nut.

**Note!**

*It may require some adjusting of the parts to make the hole appear.*

11. Fasten the lower end of the **handrail** to one of the slotted holes about midway down the side. Secure with a 3/8" x 1 1/2" bolt, lock washer and nut.