

CIH 9100 & Steiger

Seat & Suspension Kits



CHOOSE FROM

- | | | | | | | | | | |
|--|----|--|----|--|----|--|----|--|---|
| ● | OR | ● | OR | ● | OR | ● | OR | ● | |
| KM 1061 Uni Pro™
Seat & Air Suspension
PN: 6906 or 6907
Gray Fabric or Red Vinyl | | KM 1057 Uni Pro™
Seat & Air Suspension
PN: 6977
Black/Gray Matrix Fabric | | 1004 Uni Pro™ Seat &
Mech Suspension
PN: 6545
Black Fabric | | 1005 Uni Pro™ Seat &
Air/Mech Suspension
PN: 6423 or 6424
Black Fabric (Air or Mech) | | KM MSG95 Air
Suspension
PN: 6552/6550 | KM MSG85 Mech
Suspension
PN: 6553/6551 |

NEW PLUG & PLAY SEAT KITS (PNs: 6906, 6907 & 6977)
Complete plug and play wiring for easy install.

See **PAGES 2-5** for applications, drawings and additional part information.

Adjustable fold-up armrests allow easy access to the seat and individual comfort

Tapered back support and adjustable backrest adds comfort and versatility

Adjustable mechanical lumbar supports your lower back with multiple settings and provides extra back support (lever on backrest)



PN: 6907

PN: 6906

When seated, seat depth adjustment (right) and cushion angle adjustment (left) for individual fit

Air adjustment switch

Durable suspension cover keeps suspension components free of dirt and dust

Cut and sew cushions for operator comfort

Adjustable slide rails with 4" of travel

Fore/aft isolator absorbs jarring for extra comfort (Isolator can also be disabled.)

- Replacement kits for original seat
- **Grammer MSG95/741 Seat**
- Made with durable cut and sew gray fabric
- Backrest extension for extra height adjustment
- Air suspension for smoother, more comfortable ride
- Self-contained 12-volt compressor is wired to the tractor's electrical system to provide power to the suspension
- Suspension stroke of 3.94"
- Shock absorber adjusts for different settings
- 8.25" fore/aft suspension travel
- 3" height adjustment
- Comes standard with operator presence switch

PN: 6906 Includes: KM 1061 Uni Pro™ Seat & Suspension, Seat Adapter Plate, Install Hardware & Installation Instructions

PN: 6907 Includes: KM 1061 Uni Pro™ Seat & Suspension, Seat Adapter Plate, Install Hardware & Installation Instructions

Swivel is Optional (PN: 5007 for PNs: 6906 & 6907)

APPLICATIONS



Tractors

Fits - Case IH® Steiger® 9100 and Steiger® Series Tractors with Original Grammer Seat:

Steiger® 9100 Series: 9110, 9130, 9150, 9170, 9180, 9190;
Steiger® Series Lion 1000; Bearcat 1000;
Bearcat III Series: PT225, ST220, ST225;
Bearcat IV Series: CM225, KM225;
Cougar 1000 Series: CR1225, CR1280, KR1225, KR1280;
Cougar III Series: ST270, ST280; **Cougar IV Series:** CM250, CM280, CS280, KM280, KS280; **Panther 1000 Series:** CP1325, CP1360, CP1400, KP1325, KP1360, KP1400;
Panther III Series: PTA297, PTA310, PTA325, ST310, ST320, ST325, ST350; **Panther IV Series:** CM325, CM360, CS325, CS360, KM325, KM360, KS325, KS360, SM325;
Tiger III Series: ST450, ST470; **Tiger IV Series:** KP525

See PAGE 4
for drawings.

When seated, seat depth adjustment (right) and cushion angle adjustment (left) for individual fit

Air adjustment switch

- Complete seat & suspension replacement kit
- **Assembly is required (seat & suspension do not come attached)**
- **Grammer MSG95/731 Seat**
- Air suspension for smoother, more comfortable ride
- Self-contained 12-volt compressor is wired to the tractor's electrical system to provide power to the suspension compressor
- Adjustable backrest extension for extra height
- Fold-up adjustable armrests
- Shock absorber adjusts for different settings
- Suspension stroke up to 7"
- 3" height adjustment
- Durable suspension cover
- Easy access side controls
- 110 - 285 lb weight adjustment with indicator

PN: 6977 Includes: KM 1057 Uni Pro™ Seat & Suspension, Seat Adapter Plate, Install Hardware & Installation Instructions

Swivel is Optional (PN: 5007 for PN: 6977)

PN: 6977



Tapered back support and adjustable backrest adds comfort and versatility

Contoured foam cushions for operator comfort

Adjustable slide rails with 4" of travel

Fore/aft isolator absorbs jarring for extra comfort (Isolator can also be disabled.)

PN: 6545 Includes: KM 1004 Uni Pro™ Seat & Mechanical Suspension, Swivel, Install Hardware & Installation Instructions

PN: 6423 Includes: KM 1005 Uni Pro™ Seat & Air Suspension, Seat Adapter Plate, Swivel, Install Hardware & Installation Instructions

PN: 6424 Includes: KM 1005 Uni Pro™ Seat & Mechanical Suspension, Seat Adapter Plate, Swivel, Install Hardware & Installation Instructions

- Mechanical suspension with 8.25" of travel
- 4" suspension travel
- 1.375" SIP and 2.75" stroke reducer
- 286 lb weight adjustment
- Manual height adjustment
- Slide rails

PN: 6545

Armrests fold up and out of the way allowing easy access to the seat and individual comfort

Mechanical adjustable lumbar supports your lower back with multiple settings

Seat belt fixation points

Foldable and adjustable backrest angle adds comfort and versatility

Durable rubber molded suspension cover keeps suspension free of dirt and dust

Cut and sew covering for a more rugged, comfortable ride

PN: 6424

Mechanical suspension

See PAGE 4 for drawings.

Contoured foam cushions to ensure operator comfort

Durable document pouch to store owner's manual and other valuables

Adjustable fold-up armrests with lift 30° up or down

PN: 6423

Air suspension

- **Assembly is required (seat & suspension do not come attached)**
- Choose between 12-Volt air, or mechanical suspension
- Adjustable backrest folds forward and reclines
- Adjustable backrest extension for extra height
- 3-position adjustable seat height within 2.36"
- 110 - 287 lb weight adjustment
- Slide rails provide fore/aft adjustment
- Durable rubber suspension cover

FRONT VIEW
PNs: 6906 & 6907

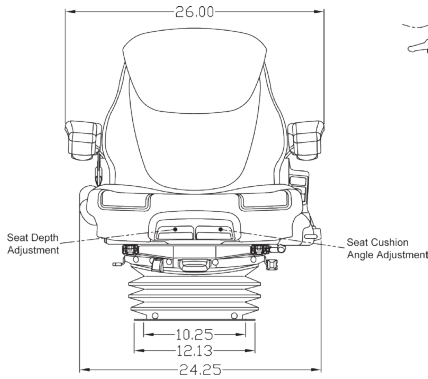

SIDE VIEW
PNs: 6906 & 6907

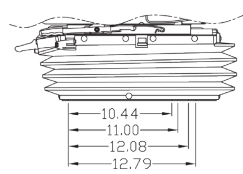

FRONT VIEW
PN: 6545

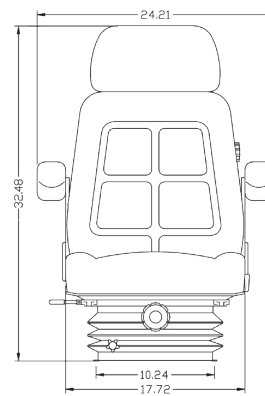

SIDE VIEW
PN: 6545

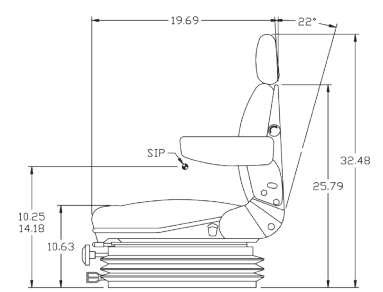

FRONT VIEW
PN: 6977

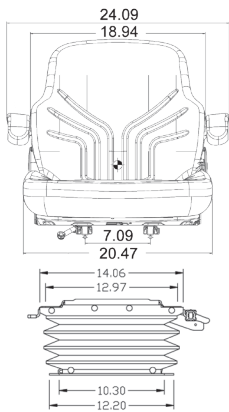

SIDE VIEW
PN: 6977

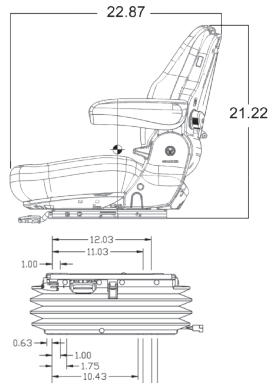

FRONT VIEW
PNs: 6423 & 6424

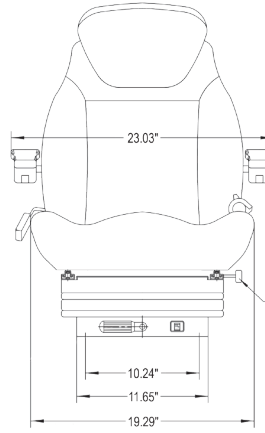

SIDE VIEW
PNs: 6423 & 6424

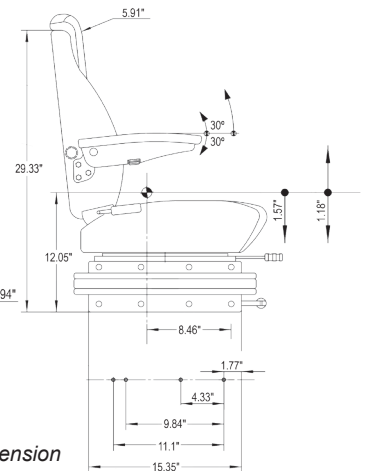

**Drawings show seat top without backrest extension and seat depth/tilt adjustment handles.*

**Drawings show mechanical suspension only and do not show swivel.*

PNs: 6550 & 6552 Include: KM MSG95 Air Suspension, Seat Adapter Plates, Slide Rails, Install Hardware & Installation Instructions

PNs: 6551 & 6553 Include: KM MSG85 Mechanical Suspension, Seat Adapter Plates, Slide Rails, Install Hardware & Installation Instructions

Must Re-Use Original Seat with or without Swivel

- Suspension replacement kit
- Self-contained 12-Volt compressor
- Fore/aft isolator absorbs jarring for extra comfort
- 4" suspension travel with suspension stroke up to 7"
- Manual weight adjustment
- 110 - 285 lb weight adjustment with weight indicator

PNs: 6550 (Original Seat with Swivel) & 6552 (Original Seat without Swivel)

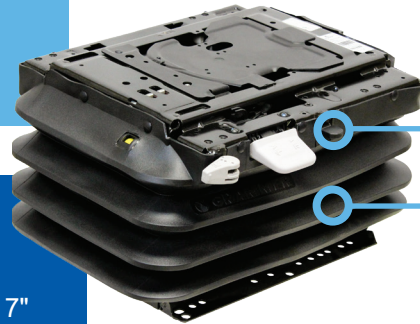

Side controls

Rubber molded suspension cover keeps suspension components free of dirt and dust

PNs: 6551 (Original Seat with Swivel) & 6553 (Original Seat without Swivel)



Rubber molded suspension cover keeps suspension components free of dirt and dust

Flip handle weight adjustment

- Suspension replacement kit
- 4" suspension travel with suspension stroke up to 7"
- 110 - 285 lb weight adjustment with weight indicator
- Three-position height adjustment
- Height adjustment of 3"

TOP VIEW
PNs: 6550 & 6552

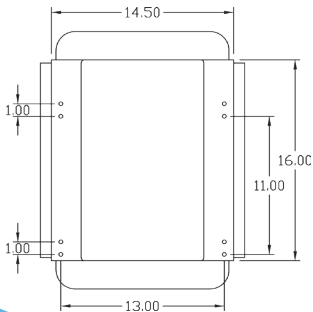

BOTTOM VIEW
PNs: 6550 & 6552

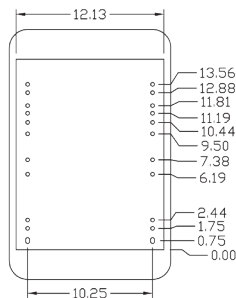

TOP VIEW
PNs: 6551 & 6553

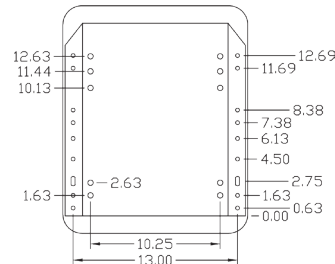

BOTTOM VIEW
PNs: 6551 & 6553

